

## £269,995

DORE AVENUE, PORTCHESTER, PO16 8DW



- Three Bedrooms
- Entrance Porch
- Lounge
- Kitchen/Diner
- First Floor Bathroom
- UPVC Double Glazed Windows
- Garage in Block
- Enclosed South Facing Rear Garden
- Harbour Views
- No Onward Chain

### Portchester Office

92 West Street Portchester Hampshire PO16 9UQ

Tel: 02392 327 070 | E: portchester@fenwicks-estates.co.uk

www.fenwicks-estates.co.uk

Property Reference: P2573

Council Tax Band: C

Score	Energy rating	Current	Potential
92+	A		
81-91	B		88 B
69-80	C		
55-68	D		
39-54	E	46 E	
21-38	F		
1-20	G		

Floor Plans (For illustrative purposes and not drawn exactly to scale)

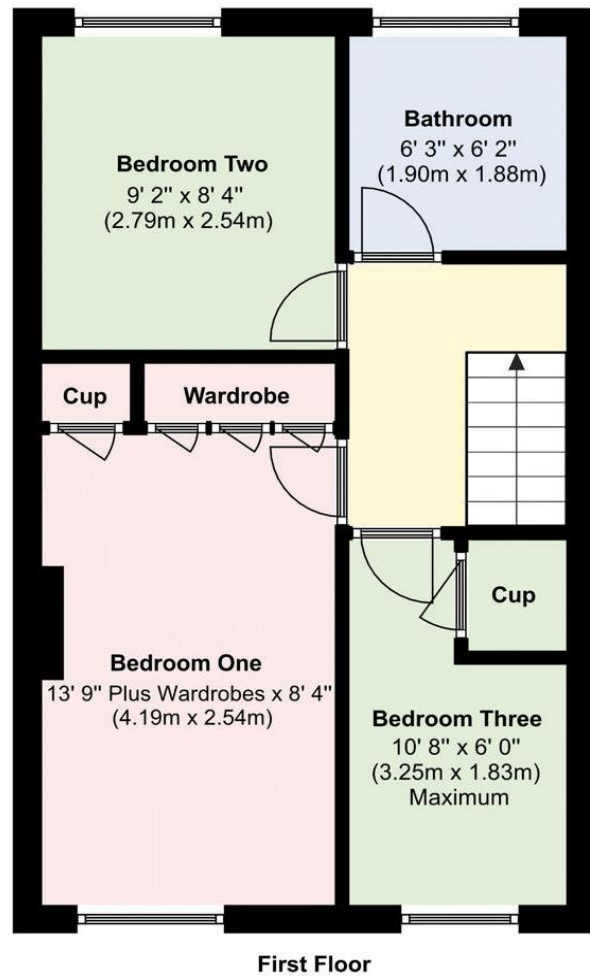
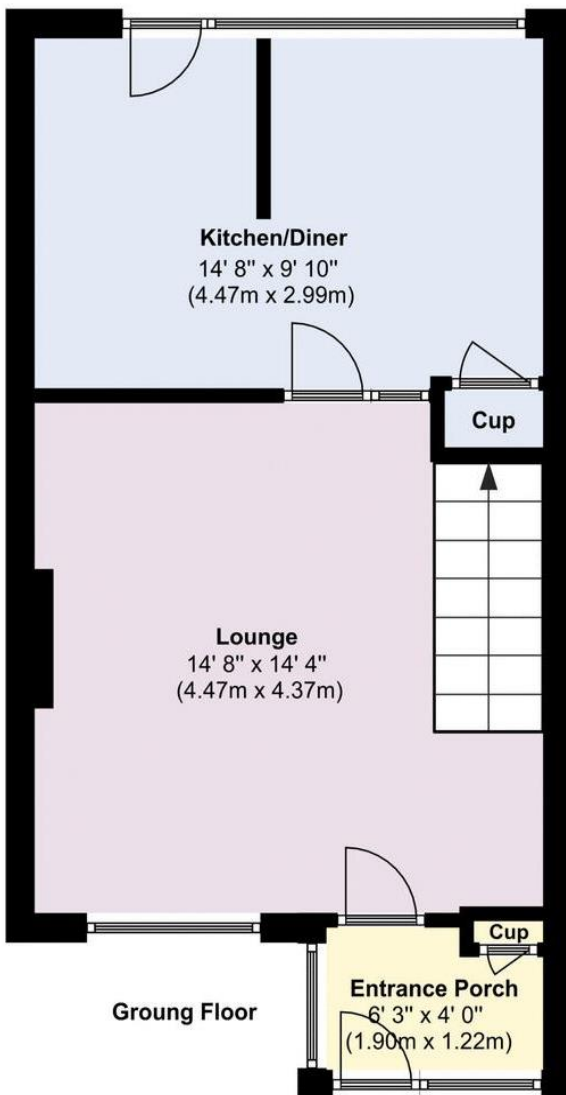

**Portchester Office**

92 West Street Portchester Hampshire PO16 9UQ  
 Tel: 02392 327 070 | E: portchester@fenwicks-estates.co.uk  
 www.fenwicks-estates.co.uk



## The Accommodation Comprises:-

Opaque UPVC double glazed front door with matching window to side into:

### Entrance Porch:-

6' 3" x 4' 0" (1.90m x 1.22m)

Opaque UPVC double glazed window to side elevation, storage cupboard housing meters and textured ceiling. Part glazed internal door to:



### Lounge:-

14' 8" x 14' 4" (4.47m x 4.37m)

UPVC double glazed window to front elevation, feature fireplace, TV aerial point, stairs to first floor and coving to textured ceiling. Glazed door with matching window to side into:



### Kitchen/Diner:-

14' 8" x 9' 10" (4.47m x 2.99m)



### Dining Area:-

UPVC double glazed window to rear elevation overlooking the garden, space for table and chairs, under stairs storage cupboard and textured ceiling.



## Portchester Office

92 West Street Portchester Hampshire PO16 9UQ

Tel: 02392 327 070 | E: portchester@fenwicks-estates.co.uk

www.fenwicks-estates.co.uk



## Kitchen:-

Fitted range of base and eye level storage cupboards, roll top worksurfaces, one and a half bowl sink unit with mixer tap, part tiled walls, space for cooker with concealed extractor over, space and plumbing for washing machine, integrated fridge/freezer, continuation of textured ceiling and UPVC part double glazed door accessing the rear garden.



## Bedroom Two:-

9' 2" x 8' 4" (2.79m x 2.54m)

UPVC double glazed window to rear elevation overlooking the garden with stunning views towards Portsmouth harbour and coving to textured ceiling.



## Bedroom Three:-

10' 8" x 6' 0" (3.25m x 1.83m) Maximum Measurements

UPVC double glazed window to front elevation, built-in storage cupboard and textured ceiling.

## First Floor Landing:-

Textured ceiling and access to loft. Doors to:

## Bedroom One:-

13' 9" Plus Wardrobes x 8' 4" (4.19m x 2.54m)

UPVC double glazed window to front elevation, built-in wardrobes, built-in airing cupboard and coving to textured ceiling.

## Portchester Office

92 West Street Portchester Hampshire PO16 9UQ

Tel: 02392 327 070 | E: portchester@fenwicks-estates.co.uk

www.fenwicks-estates.co.uk





### Bathroom:-

6' 3" x 6' 2" (1.90m x 1.88m)

Eye level opaque UPVC double glazed window to rear elevation, white suite comprising: panelled bath with Triton electric shower over, pedestal wash hand basin, close coupled WC, tiled walls, electric heater and textured ceiling.



### Outside:-

Tiered front garden with lawn, shrub borders, steps to front door and garage in block.

### Rear Garden:-

Low maintenance south facing garden, water tap, space for table and chairs for socialising purposes, water tap and wooden gate to rear for pedestrian access.



### Portchester Office

92 West Street Portchester Hampshire PO16 9UQ

Tel: 02392 327 070 | E: portchester@fenwicks-estates.co.uk

www.fenwicks-estates.co.uk



**Disclaimer:** These particulars are set out as a general outline in accordance with the Consumer Protection from Unfair Trading Regulations 2008 (CPR's) and Business Protection from Misleading Marketing Regulations 2008 (BPR's) only for the guidance of intending purchasers or lessees, and do not constitute any part of an offer or contract. Details are given without any responsibility, and any intending purchasers, lessees or third parties should not rely on them as statements or representations of fact, but must satisfy themselves by inspection or otherwise as to the correctness of each of them.

We have not carried out a structural survey and the services, appliances and specific fittings have not been tested. All photographs, measurements, floor plans and distances referred to are given as a guide only and should not be relied upon for the purchase of carpets or any other fixtures or fittings. Gardens, roof terraces, balconies and communal gardens as well as tenure and lease details cannot have their accuracy guaranteed for intending purchasers. Lease details, service ground rent (where applicable) are given as a guide only and should be checked and confirmed by your solicitor prior to exchange of contracts.

No person in the employment of Fenwicks Estates Ltd has any authority to make any representation or warranty whatever in relation to this property. Purchase prices, rents or other prices quoted are correct at the date of publication and, unless otherwise stated, exclusive of VAT.

**Data Protection:** We retain the copyright in all advertising material used to market this Property.

**Money Laundering Regulations 2017:** Intending purchasers will be required to produce identification documentation once an offer is accepted

Your home is at risk if you do not keep up repayments on mortgage or other secured loans.

## **Portchester Office**

92 West Street Portchester Hampshire PO16 9UQ

Tel: 02392 327 070 | E: portchester@fenwicks-estates.co.uk

[www.fenwicks-estates.co.uk](http://www.fenwicks-estates.co.uk)

